

70-B-58 - SPEEDLINE System Data Sheet - Version V1 (24-10-23)

SPEEDLINE 70mm 'C' Stud Partition @600mm Ctrs,
with 2x BG Gyproc 15mm WallBoard each side

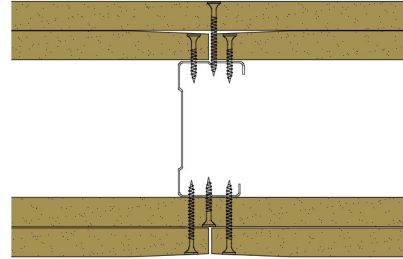

System Performance Breakdown

Fire Resistance:

BS476 Part 22:1987:

Test Ref & Date or Applied Ref & Report:

Max Height:

Thickness:

Duty Grade: BS 5234: Part 2:1992:

Sound Insulation:

60/60 Minutes (Integrity/Insulation).

BTC 13282F - BRE Report P102396-1011A

Refer to Speedline Specification Clause

132 mm. (At Base Track, Excluding Finishes)

Severe - Annexes A-F

46 R_wdB, Date Tested or Assessed Against - 70-B-57

Test Code:
H17486AA
Test Date:
14/07/2011

| Freq. Hz | R dB |
|----------|------|
| 50 | 23.4 |
| 63 | 16.2 |
| 80 | 11.4 |
| 100 | 19.9 |
| 125 | 22.4 |
| 160 | 31.1 |
| 200 | 36.2 |
| 250 | 36.9 |
| 315 | 39.0 |
| 400 | 44.0 |
| 500 | 47.7 |
| 630 | 49.5 |
| 800 | 54.2 |
| 1 000 | 55.6 |
| 1 250 | 57.7 |
| 1 600 | 61.0 |
| 2 000 | 60.9 |
| 2 500 | 52.1 |
| 3 150 | 46.9 |
| 4 000 | 49.4 |
| 5 000 | 52.4 |
| 6 300 | |
| 8 000 | |
| 10 000 | |

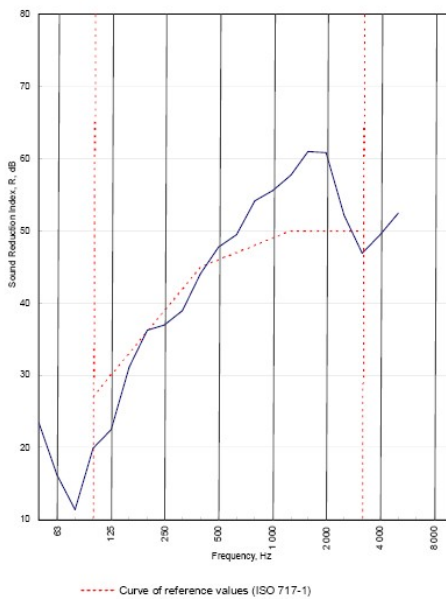

Rating according to BS EN ISO 717-1:1997 **R_w (C;Ctr) = 46 (-3;-9) dB**
 Max dev. 7.6 dB at 125 Hz
 Evaluation based on laboratory measurement results obtained by an engineering method:
 C₅₀₋₃₁₅₀ = -5 dB C₅₀₋₅₀₀₀ = -5 dB C₁₀₀₋₅₀₀₀ = -2 dB
 C₅₀₋₃₁₅₀ = -16 dB C₅₀₋₅₀₀₀ = -16 dB C₅₀₋₁₀₀₋₅₀₀₀ = -9 dB

TESTED AT ONE OF THE UKAS ACCREDITED LABORATORIES BELOW

B.T.C (H-Ref on Graph) 

B.R.E 

AIRO 

S.R.L 

Customer: Metsec plc Hepsac Division



BTC 17486A: Page 8 of 10

SPEEDLINE Drywall Systems, Adsetts House, 16 Europa View, Sheffield Business Park, Sheffield, S9 1XH.

Tel: 0114 231 8030.

Email: enquiries@speedlinedrywall.co.uk

(As per the requirements set out in ISO/IEC 17025:2017 regarding test data the results stated have been carried out by voestalpine Metsec plc as part of the contract to supply Speedline Metal Sections to SIG Plc)